

# LOS ALTOS HILLVIEW PARK & COMMUNITY CENTER

10/25/2014  
ALA Community Charette

## Design Team Concepts and Feedback

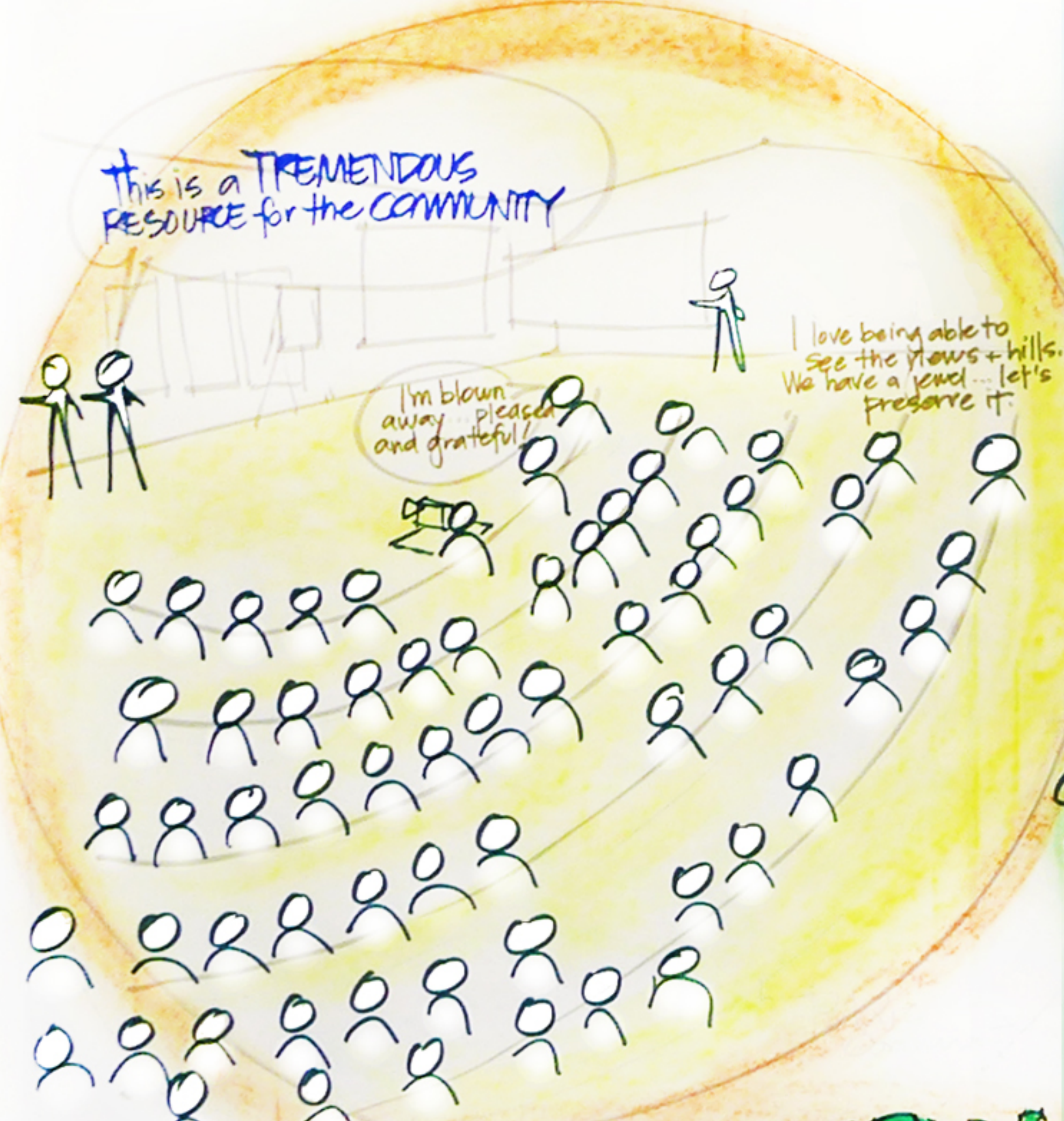

## PUBLIC REVIEW and INPUT

### Preserving the SPIRIT of LOS ALTOS



### Creating a COMMUNITY FEEL



- Solar Canopies @ Parking Some ask: Eliminate? + Parking Because of \$
- Pool is in shade-like trees around
- Strong connection @ Edith
- Amphitheater near Theater
- Turn Parking Structure 90° + push towards Hillview Buildings
- Keep Trees away from Hillview and away from Pool as much as possible.
- Swim Center: Part of Intergenerational Community Center
- Reduce road cuts and Screen 2-story building masses.

- ▶ Integrate Pool - OPEN vs ENCLOSED
- ▶ Lockers should be better integrated
- ▶ Neutral House Parking + Gazebos - A mini campus
- ▶ Underground Parking under field.
- ▶ Vehicular Access at Perimeter Favored
- ▶ Move Police off Site
- ▶ Library: 2-stories more appropriate
- ▶ Reach out to Foundations and Non-Profits... an ENDOWED FLOOR? (Build Relationships!)
- ▶ Sun and Water. Use Natural Resources
- ▶ Hillview Experience: A Natural Street scope
- ▶ Berms. Preserve Residential Feel + Mitigate Acoustics

### The HERITAGE SCHEME Plan

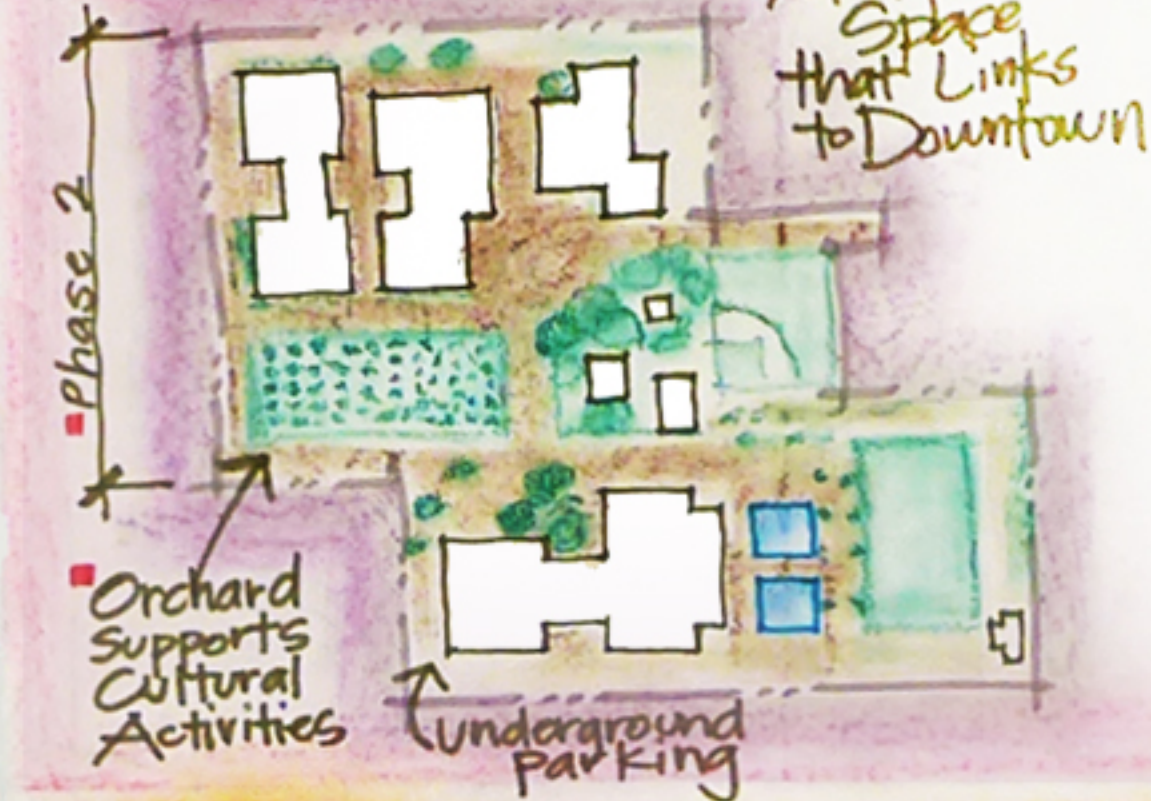

### Connecting CIVIC CENTER with DOWNTOWN and Streamlining Integration @ San Antonio

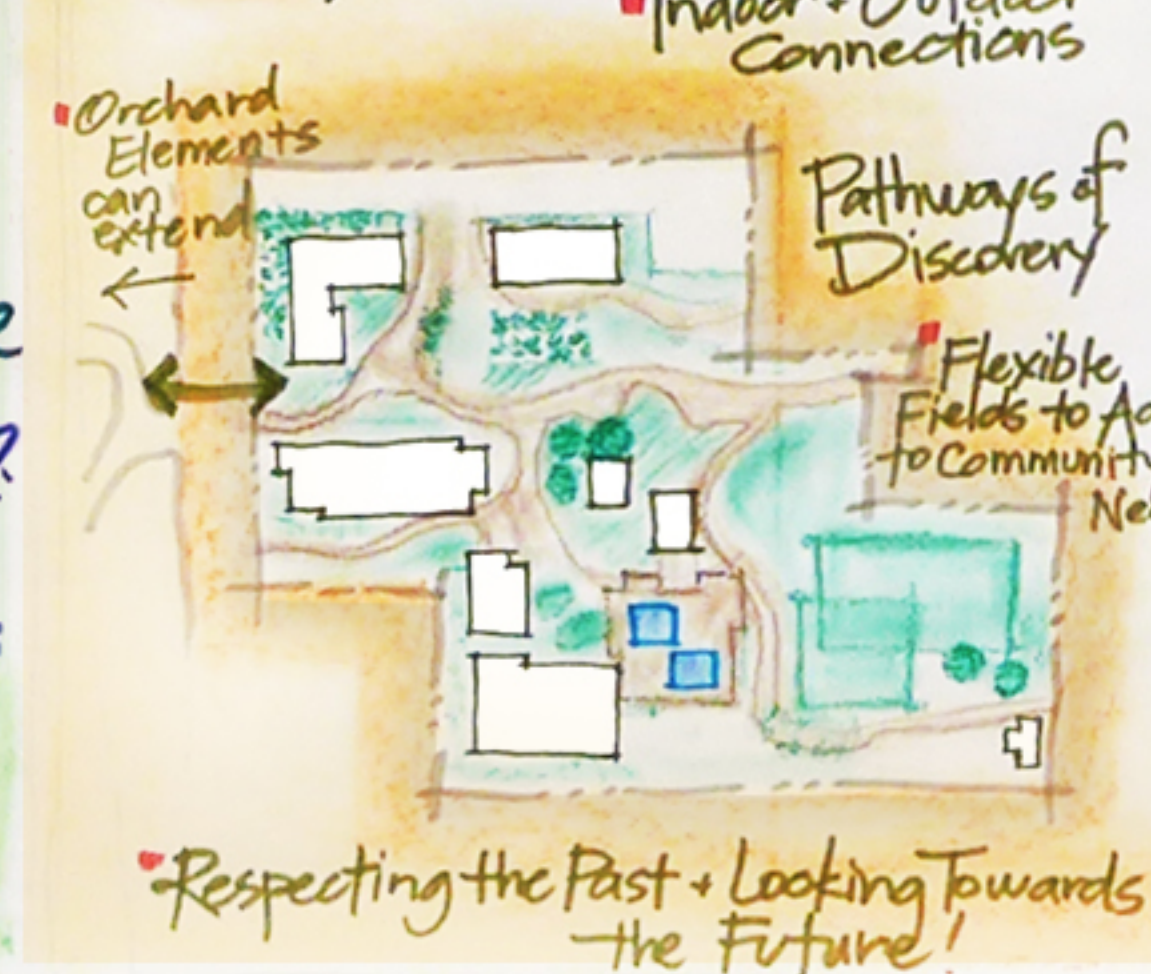

- Way too much Orchard! Some Love it!
- Love multiple ways thru site
- Relocate Police Station closer to San Antonio.
- Grand Entrance
- Pool noise may affect neighbors also love it
- Pedestrian Connections are best when located furthest South Also Connect to Downtown
- Reconsider need to increase size of community center due to slow growth.

- Maintaining 1/2 Acre of Orchard
- Love San Antonio Solution
- Extend Community to shield Pool
- Add water features Wildlife Friendly
- Study moving Police facilities off site.
- Possible Round About
- Love Intergenerational Possibilities of Different Uses.
- Rainwater Harvesting
- Permeable Pavers
- Expand Neutral House features
- Right-Size Fields

## Key Findings

- ★ Automobiles are kept OUT of the Center
- ★ Better synergy between Community Center and Downtown. Possibility to take some use to Parking Plaza.
- ★ Potential to go to 36' height limit
- ★ Look at temporarily moving City Hall to relieve some phasing constraints for more opportunities.
- ★ Appreciate Heritage of Los Altos' Architectural history
- ★ Parking Costs: Underfield vs Underbuilding
- ★ Cluster Recreational Uses Together
- ★ Use Community Center Buildings as Buffers along Edge of Site
- ★ Keeping Existing Buildings... Respect and Value
- ★ Efficiency + Cost Efficiency of Parking: 3-STORIES
- ★ SUCCESS: Diversity of Venues to attract diverse members of community (on a daily basis)
- ★ CORE GROUPS TO MAKE IT
- ★ Maintain Heritage Oaks
- ★ Consider Net-Zero Energy + Be Water Wise. Sustainability is integral in every aspect.